

gemini
ITALY

**WIFI SMART ROBOT
VACUUM CLEANER**

**WIFI無線網絡
智能自動吸塵機**

MODEL NO.: GWRVC15



A GILMAN GROUP BRAND

Please read and retain for future reference.

SAFETY INSTRUCTION - GENERAL

- Use this appliance solely in accordance with these instructions.
- This appliance is for household use only, not for commercial purpose.
- Remove all packaging material from the appliance before use.
- This appliance shall not be used by children of 0 to 8-year old.
- This appliance can be used by children older than 8-year old and persons with reduced physical, sensory or mental capabilities or lack of experience and knowledge, but only if they have been given supervision or instruction concerning use of the appliance in safe way and understand the hazards involved.
- Children should be supervised to ensure that they do not play with the appliance.
- Cleaning and maintenance must not be done by children.
- Have any repairs carried out solely by a qualified electrician. Never try to repair the appliance yourself.
- Do not handle the plug or appliance with wet hands.
- Do not immerse the main body in water.
- Children shall not play with the appliance.
- Only use the attachments/accessories supplied with the product.

SAFETY INSTRUCTION - ELECTRICITY AND HEAT

- Ensure the appliance is in placed on a horizontal, even and stable floor.
- Verify that the mains voltage is the same as that indicated on the rating plate on the appliance before use.
- Make sure that you always use a grounded wall socket to connect the appliance.
- Always remove the plug from the wall socket when the appliance is not in use.
- Remove the plug from the wall socket by pulling the plug, not the power cord.
- Make sure that the appliance, the power cord and plug do not make contact with water.
- Make sure that the appliance, the power cord and plug do not make contact with hot surface, such as a hot hob or naked flame.
- Check the appliance's power cord regularly to make sure it is not damaged.
- Do not use the appliance if the power cord is damaged. If the power cord is damaged, it must be replaced by an electrical technician or a person with similar qualification, in order to avoid any hazards.

SAFETY INSTRUCTION - DURING OPERATION

- Make sure your hands are dry before touching the appliance, power cord or plug.
- Do not pick up the appliance if it falls into water. Remove the plug from the socket immediately. Do not use the appliance again.
- Never immerse the appliance, the power cord or the plug in water or any liquid.
- Clean the appliance thoroughly after every use (Please refer to “Cleaning and Storage” Section.)
- The appliance can not aspirating an aqueous solution that may contain foaming detergent.
- Do not dismantle the vacuum cleaner while the motor is still operating.
- Never use the vacuum cleaner without the filter.
- Always keep the dust box inlet clean. Do not put any objects into it. Do not use any dust box inlet blocked until the obstacles removed.
- Never use the vacuum cleaner to vacuum up explosive, flammable or combustible liquids nor anything that may be still burning such as cigarette butts or ash/ cinders. Never vacuum up toxic materials, organic solvents or acids.
- Never vacuum up solid, sharp or piercing objects that may damage the filter.

PRODUCT OVERVIEW

Main unit

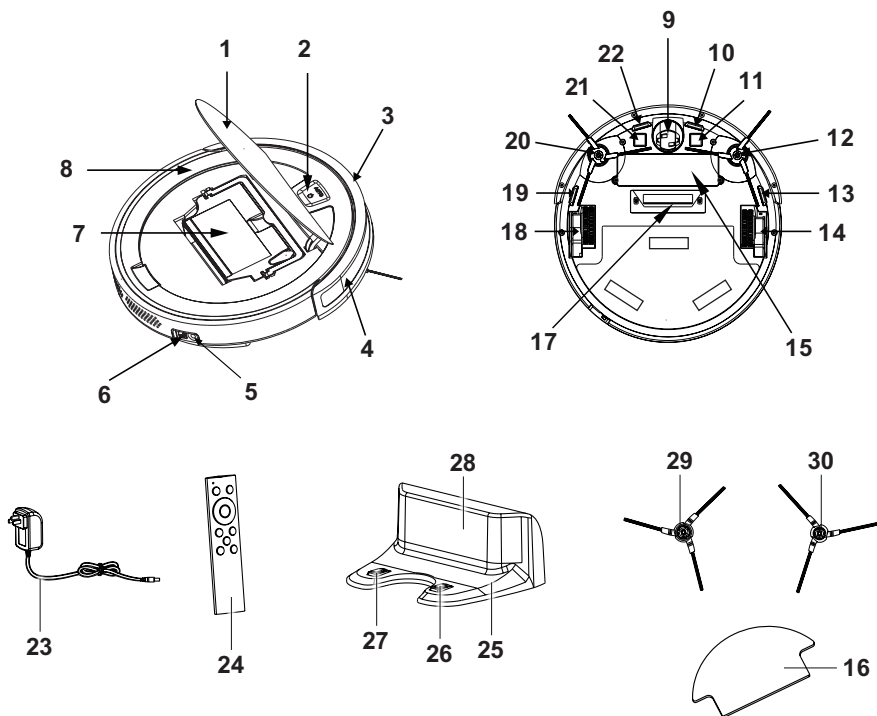







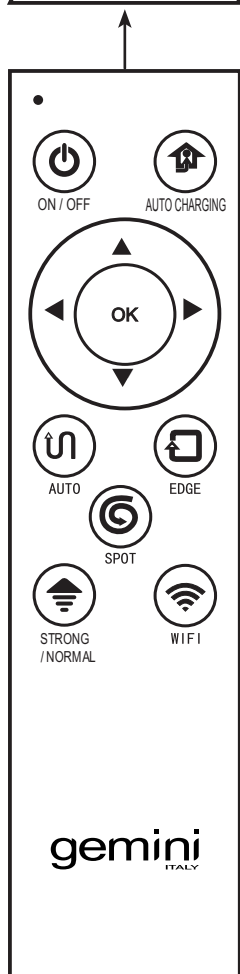

- | | |
|---|---|
| <ul style="list-style-type: none"> 1. Top cover 2. On/Off button 3. Obstacle avoidance device 4. Signal window 5. Charging Socket 6. Main power On/Off switch 7. Combined container
(Dust & water compartment box) 8. Shell 9. Universal wheel 10. Anti-drop sensor 11. Charging contact of unit (Right) 12. Left side brush (white) 13. Anti-drop sensor 14. Left wheel 15. Battery cover | <ul style="list-style-type: none"> 16. 2 Sets of Cleaning cloth 17. Dust box inlet 18. Right Wheel 19. Anti-drop sensor 20. Right side brush (orange) 21. Charging contact of unit (Left) 22. Anti-drop sensor 23. Adaptor 24. Remote control 25. Charging station 26. Charging connector 1 (Charging station) 27. Charging connector 2 (Charging station) 28. Signal window 29. Left side brush (white) (additional) 30. Right side brush (orange) (additional) |
|---|---|

Remote Control Function

Top view of
Remote control



1.  On / Off mode
2.  Auto Charging to charging station
3.  Start / Stop cleaning
4.  Direction button
5.  Start / Pause Automatic cleaning mode
6.  Start / Pause Edge cleaning mode
7.  Start / Pause Spot cleaning mode
8.  Strong / Normal suction mode
9.  WiFi connect button with mobile apps

CHARGING

1. Manual Charging

- Connect the adapter at one end of the vacuum cleaner;
- Connect the socket to the power light flashing.
- Successful charging connection. Vacuum cleaner's green indicator is flashing and hear "charging" response sound, means the vacuum cleaner is charging;
- Vacuum cleaner's green indicator remains long bright, charging is completed.
(Around 5 hours for fully charge)

Note: Please keep charging the vacuum cleaner for at least 8 hours at the first time.

Note: Before charging, please remove the wet cleaning cloth to avoid hygiene issues.

IMPORTANT: Before charging, make sure the water tank is empty.

2. Auto Charging function

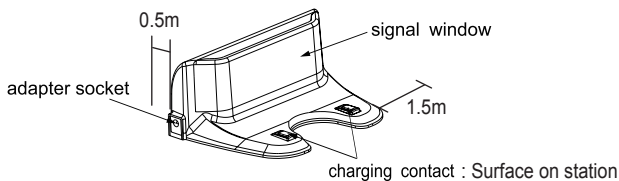

- Place the charging station flat against the wall about 0.5m and the front 1.5m without placing objects, and cannot have a strong reflecting surface such as mirrors.
- Connect the power adapter to the power supply and connect to the adapter socket of the charging station.
- When the battery is low, hear "Find Charging station" response sound from the vacuum cleaner, it will automatically look for the charging station and charging itself.

Note: Users can also control the vacuum cleaner to find a charging station by using the automatic charging function on the APP and remote controller.

WIPE CLEANING FUNCTION

The vacuum cleaner has a wipe cleaning function, the design of combined container(dust box and water compartment box) is equipped into one container, the cleaning cloth needs to attach to the bottom of the vacuum cleaner by velcosticker when using, and water will be added to the compartment of the container. The water of the water tank oozes slowly and the cleaning cloth is semi-wet, which allows to wipe cleaning and vacuum floor in the same time.

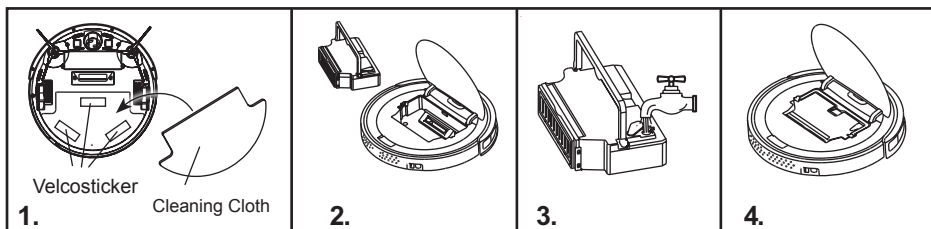

Important note for usage

- For wipe clean function, suitable for hard floor, wooden floor, tile. **DO NOT** use it on carpet.
- Before usage, it is recommended to remove the hair and dust of the two side brushes to avoid affecting the machine operation/performance.
- In order to avoid friction between the velcosticker and the hard floor, we suggest sticking the cleaning cloth when vacuum cleaning.
- Take out the combined container from unit under top cover;
- Open the water inlet cover and add water. (125ml)
- Close the water inlet cover properly and place back the combined container (dust box and water compartment box) in vacuum cleaner.
- Must remove the semi-wet cleaning cloth and water in tank after every use. It avoids direct contact with the floor for a period of time while charging, it may cause hygiene issues and machine performance.

Note: the cleaning cloth needs to attach to the bottom of the vacuum cleaner when using wipe cleaning function.

ASSEMBLY & OPERATING INSTRUCTION

Side brush explanatory chart

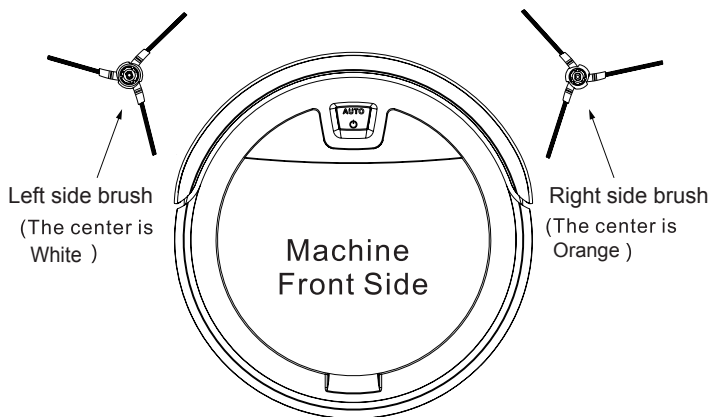

- The edge of the brush (as shown above in the center color) is not interchangeable.
- In order to ensure good use effect, users should clean the surrounding hair and other debris in time after using the vacuum cleaner for a period of time.
- The user should change the side brush according to the diagram left and right.(use the Phillips-screwdriver to remove the fixed screw and side brush)
- For the user to have good cleaning experience, please use the appliance carefully. Before cleaning, you can remove the winding object on the floor. (eg. Hair, Power cord) to help the vacuum cleaner avoid blocking the way.

Turn on the vacuum cleaner

Turn on the main power ON/OFF switch (Item 6 in page 4) (“I”power on, “O”power off). The AUTO button  on top panel turn on with green light and always bright with “Hello, Glad to serve you” response sound means successful opening.

Start cleaning

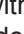
Short press AUTO button  when operation, hear “Auto Cleaning” response sound and the button with green light of AUTO button  is flashing, means start with Auto Cleaning mode.

Stop working

Short press AUTO button  once when operation, hear “Ding Dang” response sound and the button with green light always bright, the vacuum cleaner will stop, press again, the vacuum cleaner resumes working again.

Turn off the vacuum cleaner

After stop working, turn off the main power switch (item 6), to turn off the vacuum cleaner.

MODE SELECTION

In order to adapt to different ground conditions and realize deep cleaning, this product has a variety of cleaning modes. User can use the mobile APP and remote control different cleaning mode, and users can also adjust use the APP direction by using remote control to help machine get out of barrier situation.

Important note for usage

- This machine is suitable for hard floor, wooden floor, tile, carpet (The height of short fluff must be less than 0.8 cm, otherwise the vacuum cleaner will not work properly).
- Before usage, it is recommended to remove the hair and dust by the side brushes to avoid affecting the machine. Take out the combined container from unit under top cover;

Auto Cleaning mode (Mapping function)

Choose Auto Cleaning mode, hear “Auto Cleaning” response sound from the vacuum cleaner, it will plans full coverage cleaning.

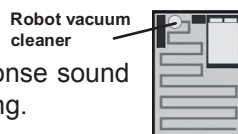

Edge Cleaning mode

Choose edge cleaning mode, hear “Edge Cleaning” response sound from the vacuum cleaner, it will along with the object edge cleaning (such as wall edge) especially cleaning the corner of the house.



Spot Cleaning mode

Choose Spot cleaning mode, hear “Spot Cleaning” response sound from the vacuum cleaner, it will focus on specific areas, cleaning more thorough and pause after finish the spot cleaning. Spot cleaning mode is recommended use in the living room or other areas with fewer obstacles.



Strong / Normal suction mode

Press Strong / Normal suction mode, hear “Strong mode” response sound from the vacuum cleaner. It means Strong mode under Auto Cleaning mode and can apply to Edge or Spot Cleaning mode, Press Strong / Normal suction mode again, hear “Normal mode” response sound. It means Normal mode under Auto Cleaning mode and can apply to Edge or Spot Cleaning mode.



Auto Charging function

Choose “Dock” function, or when the power is lower of the vacuum cleaner, hear “Find Charging station” response sound from the vacuum cleaner, it will find the charging station automatically,

7 days preset on cleaning function

Use mobile APP control to preset on cleaning time and cleaning mode.

Day: from Monday to Sunday

Time: 1-24 hours

MOBILE APP USAGE

Scan the QR code, download and install the Tuya Smart App  for mobile control function, please reference the APP interface below.

Vacuum cleaner WiFi setting

Turn on main power switch (Item 6: I power on) and press AUTO button  on top panel about 5 seconds (or remote controller press the WiFi button), hear “WiFi Setting” response sound from the vacuum cleaner, which means WiFi works under in EZ mode (default mode). If you hear “Dingdong” response sound, which means WiFi works under in AP mode. After the machine enters WiFi setting, add the device to the APP interface and connect the WiFi distribution network.



Picture 1

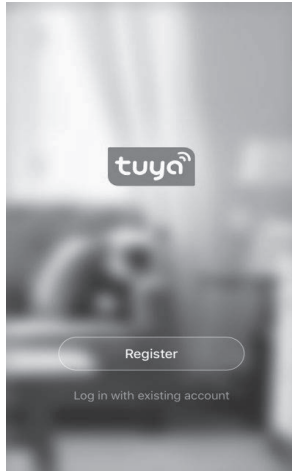

Picture 2



Picture 3

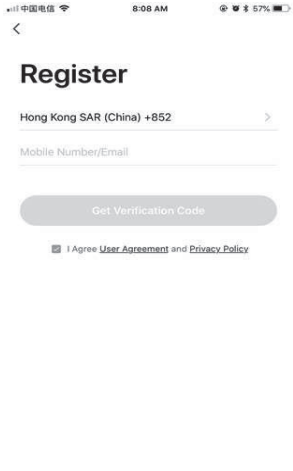

- Open Tuya Smart App and press to create New Account. (Picture 1)
- Enter the privacy policy interface and press Agree. (Picture 2)
- Input your phone number or email address to get a verification code to register. (Picture 3)

Picture 4

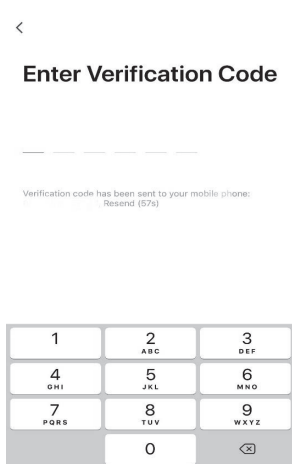

Picture 5

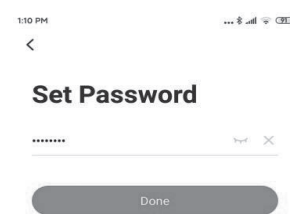

Picture 6

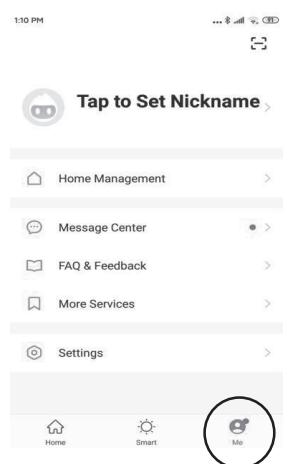

- Enter the Verification code.(Picture 4)
- Set the password (1-20 characters, including alphabets and numbers) and tap Done. (Picture 5)
- Tap “Me” to set your home account (e.g.Home name & Home location) if needed. (Picture 6)

Picture 7

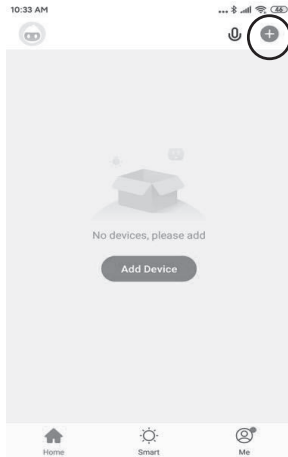

Picture 8

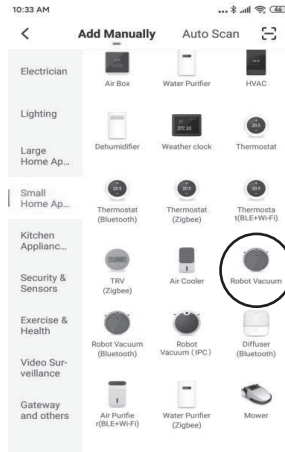

Picture 9

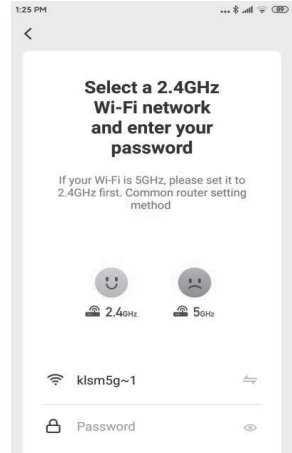

- Tap the “+” icon on the right corner of APP to enter into “Select Device Type” (Picture 7)
- After tap the “+” icon on the right corner of APP , interface choose “Small Home Appliances”, select “ Robot Cleaner” into “Add device” interface. (Picture 8)
- Select a 2.4GHz Wi-Fi network and enter your password. (Picture 9)

Picture 10

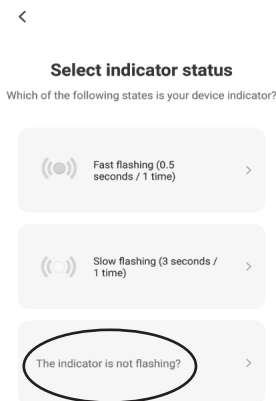

Picture 11

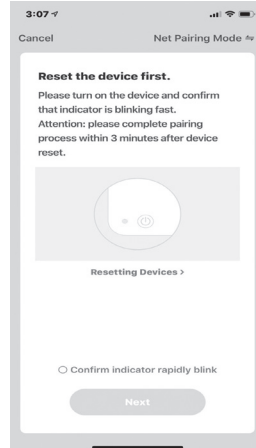

- Enter indicator status selection interface. Select “The indicator is not flashing?” If without this interface, please go to next step. (Picture 10)
- Tap “Net Pairing mode” in the interface and select EZ mode (default mode). (Picture 11)
- Turn on machine main power switch and press and hold AUTO button on the top cover about 5 seconds (or use remote controller WiFi button), hear “WiFi Setting” response sounds, which means WiFi works under in EZ mode (default mode). Select “Confirm indicator rapidly blink” and go next in the interface.

Picture 12

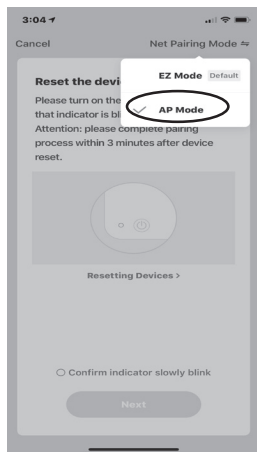

Picture 13

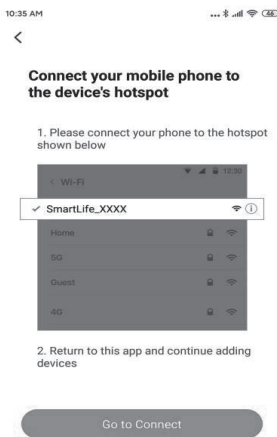

Picture 14

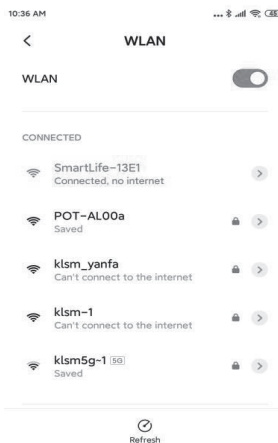

- If EZ mode (default mode) connect to WiFi is failed. Please try to select “AP mode” in the interface. (Picture 12)
- Turn on machine main power switch and press and hold AUTO button on the top cover about 5 seconds (or use remote controller WiFi button), hear “DingDong” response sounds, which means WiFi works under in “AP mode”. Select “Confirm indicator rapidly blink” and go next in the interface.
- Search your mobile with device’s hotspot smartlife_XXXX and choose “Go to connect”.(Picture 13)
- Connect hotspot smartlife_XXXX and tap back button in your mobile phone. (Picture 14)

Picture 15

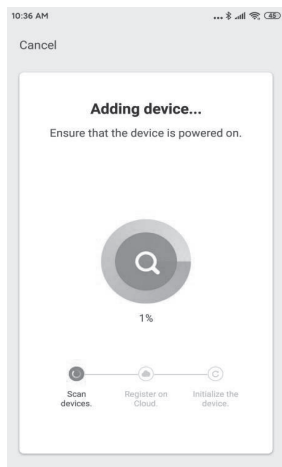

Picture 16

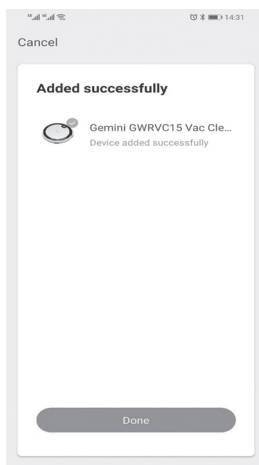

Picture 17

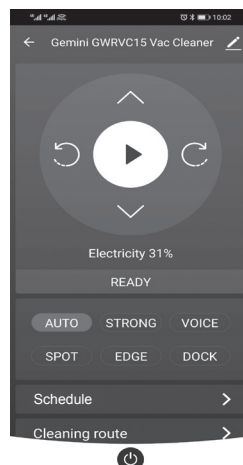

- Adding the device until 100% complete in interface. (Picture 15)
- Wait for the device added successfully, then tap “Done”. (Picture 16)
- You can select your desired cleaning mode (Auto/Strong/ Spot/Edge), voice (on/off) and Dock (return charging) by the control panel. (Picture 17)

Picture 18

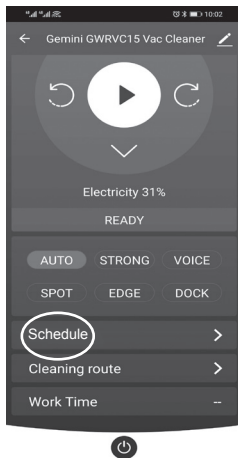

Picture 19

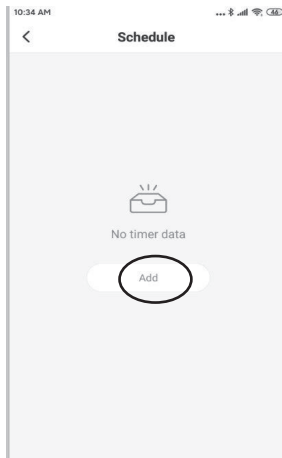

Picture 20

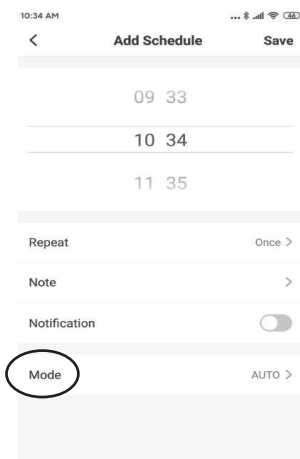

Picture 21

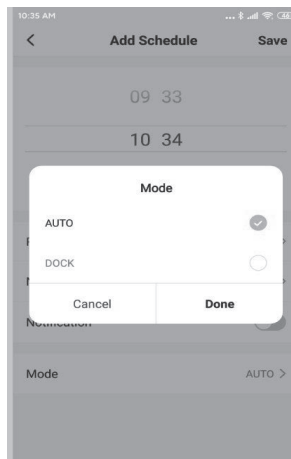

- Press Schedule (Time: 1-24 hours ; Date: Monday to Sunday) to pre-set timer on and select the mode (Auto Cleaning or return charging) or press Cleaning route to check the cleaned area. (Picture 18-21)

Note:

- **The appliance must be connected with power supply and WiFi.**
- **Due to the continuous product improvement and updates on the Mobile APP interface, the above mentioned data and user interfaces are only for reference. The actual APP interface is subjected to the final download version and won't notice to user in advance.**

CLEANING AND STORAGE

Combined container (dust box and water compartment box) & Filter

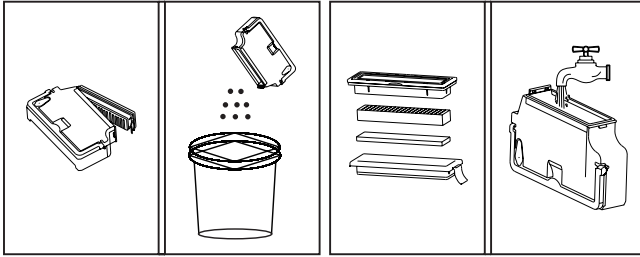

- Remove the combined container and clean up the garbage in dust compartment.
- Remove the filter component and rinse the filter and combined container with water gently, let it air-dry completely before reassemble.

Cleaning Cloth

- Clean and dry the cleaning cloth after mop finished every time.
- Must remove the semi-wet cleaning cloth and water in tank after every use. It avoids direct contact with the floor for a period of time while charging, it may cause hygiene issues and machine performance.

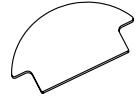

Dust box Inlet & Side brush

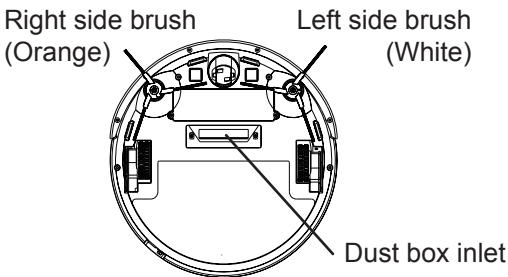

To Keep the cleaning performance, clean the dust box inlet and side brushes regularly.

1.Clean up the dust box inlet:

Please use a wet cloth to clean the rubber-flap gently.

2.Clean up the side brushes:

Use a Phillips-screwdriver to remove the screws. Take out the side brushes and remove the dirty-hair / dust from the brushes. Beware the direction before re-install them back to position.

Universal wheel

Pic.1
universal wheel

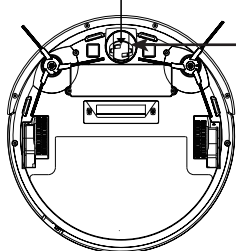

Pic.2

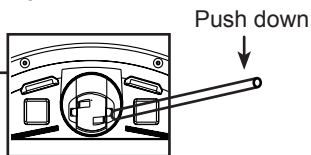

Pic.3

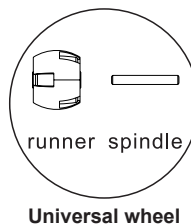

Use a screw to push down and remove the universal wheel as the picture, then clean the runner and spindle with a dry cloth.

Charging Contact

Charging contact of unit
(right)

Charging contact of unit
(left)

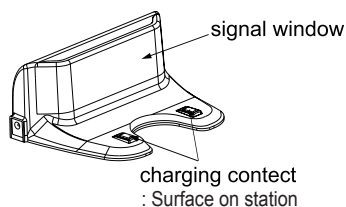
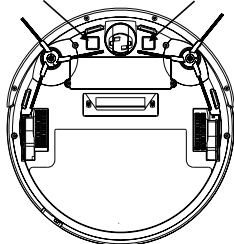



Wipe the charging contacts and signal window by a dry cloth without any objects, ensure the automatic charging process of the vacuum cleaner fluently.

Vacuum cleaner Housing

Use a dry cloth wipe the vacuum cleaner housing.

NOTE: All parts must dry thoroughly before installing into the machine.

TROUBLESHOOTING

PROBLEM	CAUSE	SOLUTION
Vacuum cleaner not working	Vacuum cleaner (both main ON/OFF switch and AUTO button  on the top panel) not turn on	Turn on the main power switch (Item 6) and AUTO button  (Item 2).
	Run out of battery	Ref to page 6, "Charging" part.
Vacuum cleaner cannot charge	Charging connections are unreliable	Make sure the adapter connect effectively
		Wipe Charger and charging contact
Vacuum cleaner keep backward	The ground sensor has a foreign matter	Use dry cloth wipe the sensor
Vacuum cleaner is in circles	The signal window of the vacuum cleaner with foreign matter	Use dry cloth wipe the signal window
Left/ right wheel abnormal, hear "Left wheel error" or "Right wheel error" response sound	The wheels were wound by obstacles	Remove the obstacles
Side brushes abnormal ,hear "Left brush error " or "Right brush error response sound	Left/ right side brush setup error	Install the side brush properly. Refer to page 7 "side de brush explanatory chart" part
Combined container (dust box and water compartment box) abnormal ,hear "Dust box error response sound	Combined container (dust box and water compartment box) was not put in place	Combined container (dust box and water compartment box)in place
Universal wheel abnormal	Universal wheel with obstacles	Remove the obstacles. Ref to page 16 "Universal wheel" part
Vacuum motor error, hear "Vacuum motor error" response sound	Motor with obstacles	Vacuum Motor Error: Contact our after sales customer service centre for assistance.
App cannot be used	Network connection failed	Ref to page 10-14 "WiFi USAGE"
Remote control insensitive	Too far away from the vacuum cleaner	Alignment the AUTO button  in effective distance. (within 3 metres)

PROBLEM	CAUSE	SOLUTION
Other abnormal situation	Unknown reasons	Restart the machine to solve (turn off the main power switch, put machine on the flat area, then turn on it

If the above investigation fails to solve the problem, please contact our after-sales service. Do not disassemble the machine by yourself.

PRODUCT SPECIFICATIONS

Model no.: GWRVC15
Voltage: 14.6V
Power: 20W
Battery: Li-ion 2150mAh
Product dimensions: 325 (W) x 56 (H) x 325 (D) mm

*The final product specification may be varied according to a different lot of material and actual input voltage power of the usage area.

閱讀下列說明事項並請妥善保管，以供日後參考。

安全指引 - 一般安全

- 請按照這些說明事項，使用本產品。
- 本產品僅供家用，不作商業用途。
- 使用前，請將所有包裝材料拆除。
- 0至8歲的兒童不應使用本產品。
- 超過8歲的兒童可使用本產品，但請勿由肢體不健全、感覺或精神上有障礙或缺乏相關經驗和知識的人使用，除非有負責他們安全的人對他們使用本產品進行監督或指導。
- 請務必看顧好兒童，以確保他們不玩耍本產品。
- 兒童不應清潔或維修本產品。
- 當需進行任何維修，必須由專業維修人員進行維修。永遠不要嘗試自己修理本產品。
- 手濕時不可以接觸電源插頭或本機。
- 主機不可以浸入水中。
- 兒童不可以把玩本機。
- 只使用隨機附送的配件。

安全指引 - 電子和熱能產品

- 請把本產品放置和平穩的表面上使用。
- 使用相符的電源和電壓，以防止觸電。
- 本產品只能使用帶接地線的電源插座。
- 當本產品不使用時，請從牆上的插座中拔掉插頭。
- 從牆上插座中拔掉插頭時，應拿著插頭而不是電源線。
- 確保本產品、電源線和插頭不與水接觸。
- 確保本產品、電源線和插頭不接觸發熱表面，如明火。
- 定期檢查本產品的電源線以確保其沒有損壞。如果電源線損壞，請勿使用其產品，並須由專業維修人員來更換，以避免出現任何危險。

安全指引 - 操作期間

- 請勿用潮濕的手插拔電源插頭或接觸本產品。
- 如果本產品落入水中，立即從插槽中拔下插頭，並且不要再次使用本產品。
- 切勿將本產品、電源線或插頭浸入水中或其他液體中。
- 使用後徹底清潔本產品 (請參閱“清潔和保養”)
- 不可吸入任何可能產生泡沫的洗滌劑或水溶液。
- 產品運作時，不可拆卸本產品。
- 確保過濾網組件安裝好，才可使用本產品，否則可能造成損壞。
- 吸塵口不得遮蓋或堵塞。吸塵口被阻塞時不可使用。
- 不可使用本產品吸入任何正在燃燒/燃點的物品，如燃點的香煙或煙灰。不可吸入任何爆炸性物質、易燃性物品、可燃性液體、高溫物品、毒性物質、有機溶劑、腐蝕性或強酸性物質。
- 不可吸入如玻璃碎片、釘子、石頭、針頭或刀片等邊緣銳利的物品。以免過濾器受損。

部件示意圖

主機

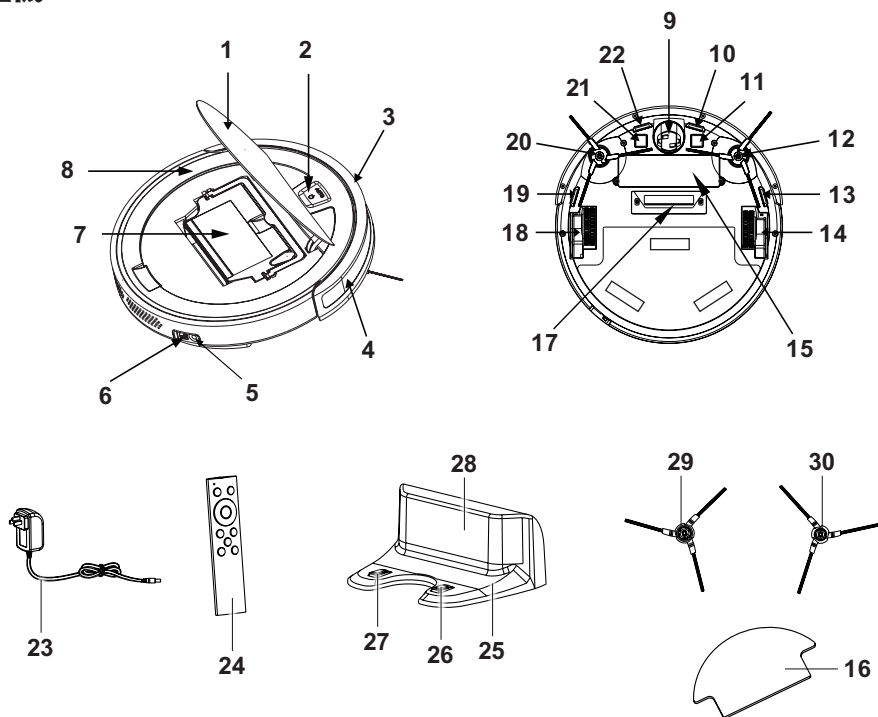

- | | |
|-------------------------|---------------------|
| 1. 頂蓋 | 16. 抹布 x 2塊 |
| 2. 開/關按鍵 | 17. 吸塵口 |
| 3. 前撞 | 18. 右輪 |
| 4. 透視窗 | 19. 地檢感應器 |
| 5. 充電插孔 | 20. 右邊刷 (橙色) |
| 6. 主機電源開關 | 21. 充電極片2 (主機左方) |
| 7. 組合容器盒
(塵箱及水箱分隔設計) | 22. 地檢感應器 |
| 8. 面蓋 | 23. 火牛 |
| 9. 方向輪 | 24. 遙控器 |
| 10. 地檢感應器 | 25. 回充座 |
| 11. 充電極片1 (主機右方) | 26. 充電極片1 (回充座) |
| 12. 左邊刷 (白色) | 27. 充電極片2 (回充座) |
| 13. 地檢感應器 | 28. 訊號發射窗 |
| 14. 左輪 | 29. 左邊刷 (白色) (附加配件) |
| 15. 電池蓋 | 30. 右邊刷 (橙色) (附加配件) |

遙控器

遙控器頂部



紅外線發射器 (距離：3米)

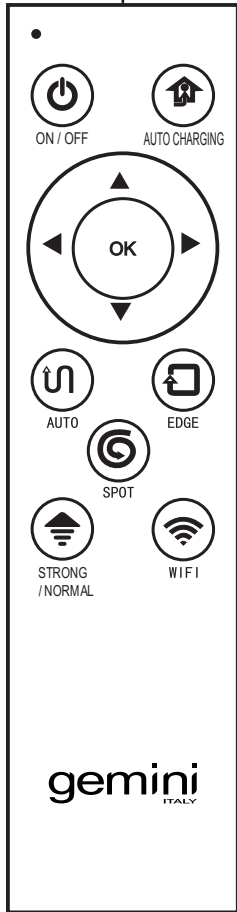

1.  開 / 關機模式
2.  自動回充電座功能
3.  開啟 / 暫停清潔
4.  方向按鍵
5.  開啟 / 暫停自動清潔模式
6.  開啟 / 暫停沿邊清潔模式
7.  開啟 / 暫停點 / 旋轉模式
8.  強力 / 正常吸力模式
9.  手機APP聯網按鍵

充電

手動充電

- 將火牛一端與吸塵機充電插口連接，另一端與電源連接，機頂按鍵指示燈閃爍，並聽到“Charging”聲響，充電連接成功。
- 吸塵機頂蓋上綠色指示燈閃爍，代表充電中；
- 吸塵機頂蓋上綠色指示燈常亮，充電完成。(約5小時充滿電)

注意：首次使用，請連續充電 8小時以上。

注意：在充電前，請取下濕了的抹布，以避免衛生問題。

重要提示：吸塵機充電時，確保組合容器上盒內的水箱分隔盒中沒有水。

自動充電

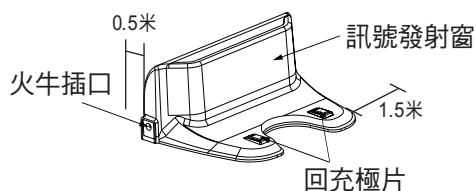

- 將回充座平坦靠牆放置，左右0.5米 及前方1.5米內不要放置物品，且不能有鏡子等反射面較強物體。
- 將火牛連接電源，並與連接回充座上的火牛插口。
- 在電量不足時，並聽到“Find charging station”聲響，吸塵機會自動尋找回充座並進行充電。
- 用戶也可以通過手機APP和遙控器上(自動回充電座功能)的返回充電功能，控制吸塵機尋找回充座進行充電。

抹地功能

吸塵機具有抹地功能，採用組合容器盒內水箱設計，使用時，將抹布貼在機器底部相應位置(魔術貼位置)，並參照圖示水箱入口位置加水。水箱的水慢慢滲出，抹布呈半濕狀，從而做到抹地功能。

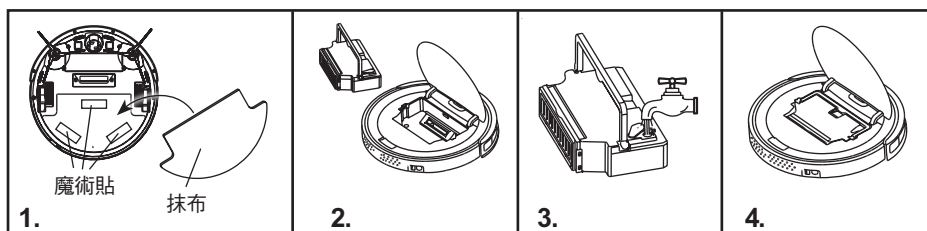

使用注意事項

- 抹地功能適用於硬地板，木地板，瓷磚。**不適合**在地毯上使用。
- 使用前，建議把兩邊毛刷纏繞的毛髮及塵埃先取走/消走以免影響產品。
- 為了避免魔術貼與地板磨擦，建議在使用吸塵時，也貼上抹布。
- 打開頂蓋，取出組合容器盒。
- 打開水箱的塞子加水(125毫升)。
- 裝好塞子，把組合容器盒裝回原位，合上頂蓋。
- 每次使用後必須移除半濕的清潔抹布和清空水箱中的水才充電，避免抹布長時間直接接觸地板，影響衛生及機件效能。

注意：進行抹地功能時，請將抹布緊貼在機器底部。

安裝及使用說明

邊刷圖示

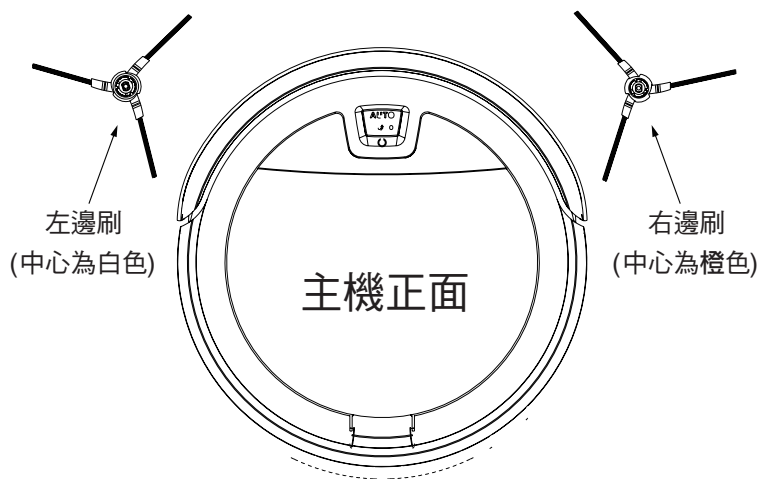

- 邊刷分左右 (如圖以中心顏色區分) 且左右不能互換；
- 邊刷周圍可能纏繞毛髮等雜物，而減弱清潔功能。需要及時清理邊刷
- 用戶在更換邊刷時，須按照圖示左右進行更換 (取下邊刷用十字螺絲刀固定位置)；
- 為使用戶有良好的清潔效果，請謹慎使用本機。清潔前，您可以取去地板上較多的纏繞物。(例如，毛髮，電源線) 以避免吸塵器堵塞，影響吸力效能。

打開主機

打開主機側面主電源開關(第17頁第6項) (“I” 為開機，“O” 為關機)，並聽到“Hello, Glad to serve you” 聲響，頂蓋上的AUTO按鍵綠色指示燈亮起，並且常亮，代表開機成功。

啟動清潔

短按一次頂蓋上主機AUTO按鍵 ，並聽到“Auto Cleaning” 聲響，即可啟動自動清掃模式。

暫停工作

吸塵機在工作中，短按一次頂蓋上主機AUTO按鍵 ，並聽到“叮噠” 聲響以及綠色指示燈長亮，吸塵機將停止工作。再按一次鍵，主機即恢復自動清潔。

關機

暫停工作後，關閉主機側面電源開關，按鍵指示燈熄滅，關機成功。

模式選擇

為適應不同地面狀況，並有效地清潔，本產品設有多種清潔模式，可按需要通過手機APP和遙控器進行選擇，當機器異常停止工作時，用戶也可通過手機APP和遙控器上的方向鍵移動機器。

使用注意事項

- 本機適用於硬地板，木地板，瓷磚，地毯(短絨毛高度必須小於0.8厘米, 否則吸塵機不能正常運作)。
- 使用前，建議把兩邊毛刷纏繞的毛髮及塵埃先取走/消走以免影響產品。

自動清潔模式 (自動導航)

選擇自動清潔模式，並聽到“Auto Cleaning”聲響，吸塵機將自動進行隨機式清潔。

智能自動吸塵機



沿邊清潔模式

選擇自動清潔模式，並聽到“Edge Cleaning”聲響，吸塵機將針對室內邊角處進行清潔，吸塵機固定物體(如牆壁)周邊進行清掃。

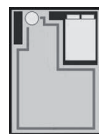

重點/旋轉型清潔模式

選擇自動清潔模式，並聽到“Spot Cleaning”聲響，吸塵機將針對特定區域進行隨機旋轉型清潔掃，在完成清潔後會暫停，重點/旋轉清潔模式，使清潔得更徹底，建議在客廳等障礙物較少的大面積區域使用。



強力/正常吸力模式

按強力/正常吸力模式，聽到“Strong mode”聲響，這表示強力吸力模式下的自動清潔，也可切換至沿牆或重點/旋轉清潔模式，再按強力/正常吸力模式一次，聽到“Normal mode”聲響，這代表正常吸力模式下的自動清潔，也可切換至沿牆或重點/旋轉清潔模式。



自動返回充電模式

選擇自動返回充電模式，並聽到“Find charging station”聲響，吸塵機將自動尋找回充座進行充電，或於低電量時，吸塵機也會自動尋找回充座進行充電。

7天預設開啟清潔模式

使用手機APP上設定開始清潔時間和清潔模式。

日子: 星期一至星期日

時間: 1至24小時

手機APP使用

手機APP下載及說明

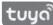
掃描圖中QR，下載並安裝Tuya Smart App ，更多功能，請參考APP介面提示。



主機WiFi設置

開啟吸塵機主電源(機側)，長按機頂蓋上AUTO按鍵  約五秒 (或通過短按遙控器上的“WiFi”按鍵)，提示“WiFi Setting”語音響起，代表“Wi-Fi 快速 (默認) 模式”。若聽到聲到“叮噠”聲響，代表熱點配網“兼容模式”。主機進入WiFi設置後，依提示進行WiFi配網連接。

圖1



圖2



圖3



- 打開Tuya Smart App，然後按創建新帳戶。(圖1)
- 進入隱私策略界面，然後按同意。(圖2)
- 輸入您的電話號碼或電子郵件以獲取驗證碼進行註冊。(圖3)

圖4

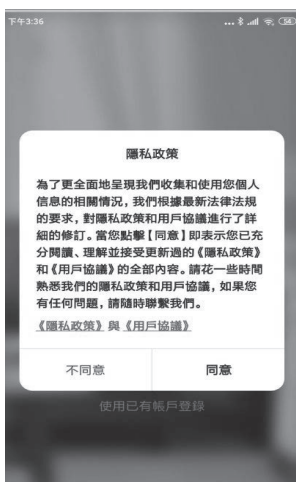

圖5



圖6



- 輸入驗證碼。(圖4)
- 設置密碼（1-20個字符，包括字母和數字）(圖5)
- 按“我”添加家庭帳戶（家庭名稱和家庭位置）如需要。(圖6)

圖7



圖8



圖9



- 點擊APP右上角的“+”圖標，進入“選擇設備類型”界面。(圖7)
- 點擊APP右上角的“+”圖標後，選擇“小家電”，選擇“掃地吸塵機”，進入“添加設備”界面。(圖8)
- 選擇一個2.4GHz Wi-Fi網絡並輸入密碼。(圖9)

圖10



圖11



- 進入指示燈狀態界面。選擇“指示燈未閃爍?”，如沒有此介面，請直接去下一步。(圖10)
- 點擊手機APP右上角“配網模式”。選擇“Wi-Fi 快連(默認)模式”(圖11)
- 開啟吸塵機主電源(機側)，長按機頂蓋上AUTO按鍵  約五秒(或通過短按遙控器上的“WiFi”按鍵)，提示“WiFi Setting”語音響起，代表“Wi-Fi 快連(默認)模式”。這時候在介面上選取“確認指示燈在快閃”，再按下一步連接。

圖12



圖13



圖14

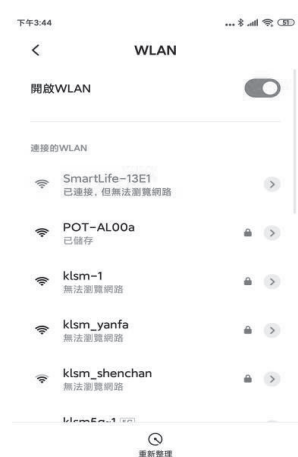

- 若“WiFi快連(默認)模式”連接WiFi失敗，可選擇熱點配網“兼容模式”連接WiFi。(圖12)
- 開啟吸塵機主電源(機側)，長按機頂蓋上AUTO按鍵約五秒(或通過短按遙控器上的“WiFi”按鍵)，提示“叮咚”語音響起，代表熱點配網“兼容模式”，這時侯在介面上選取“確認指示燈在慢閃”，再按下一步連接。
- 查找熱點 smartlife-XXXX，按去連接。(圖13)
- 連接熱點 smartlife-XXXX，連接成功後，然後點擊手機上的返回鍵。(圖14)

圖15



圖16



圖17



- 添加設備直到100%完成。(圖15)
- 等待設備添加成功，然後在按“完成”。(圖16)
- 您可以通過控制面板選擇所需的清潔模式（自動/強力/重點/邊牆），語音提示（開/關）和回充(圖17)

圖18



圖19



圖20



圖21



- 按預約開機時間設定（時間：1-24小時；日期：週一至週日）或按清潔路線查看已清潔的區域。（圖18至圖21）

重要注意事項：

- 設備必須連接電源和WiFi。
- 由於本產品及手機軟件程式使用界面會不斷改良及更新，以提升用戶使用體驗。以上文中列出的軟件使用界面內容及數據只供參考。最新的使用界面需按當時下載的軟件版面為實，不會另行通知。

清潔和保養

組合容器盒 (塵箱及水箱分隔設計)及過濾網

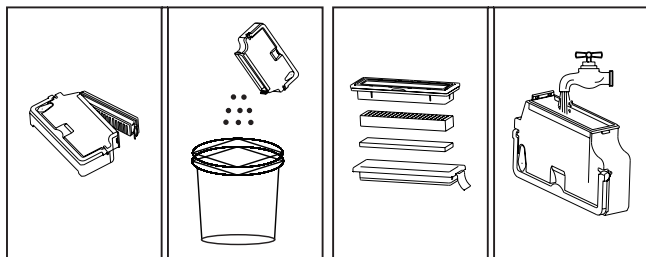

- 取出組合容器盒，清理塵箱中的垃圾。
- 拆下過濾網部件，用乾淨水輕輕地沖走灰塵，以及沖洗組合容器盒，待完全清潔及完全風乾才裝回過濾網。

抹布

- 每次抹地完畢後，輕輕地從主機底部取下抹布進行清洗並風乾。
- 每次使用後必須移除半濕的清潔抹布和清空水箱中的水才充電，避免抹布長時間直接接觸地板，影響衛生及機件效能。

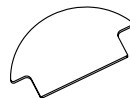

吸塵口和邊刷

右邊刷 (橙色)

左邊刷 (白色)

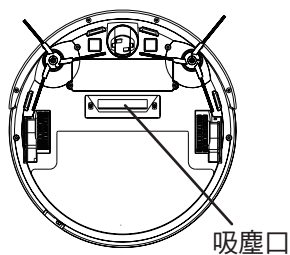

為保持清潔效能, 建議定時清理吸塵口和邊刷:

1. 清理吸塵口:

可用濕布輕擦吸塵口軟膠。

2. 清理邊刷:

先用十字螺絲刀拆下邊刷，清理纏繞邊刷上的毛髮或灰塵，然後注意裝配方向，裝回原位。

萬向輪

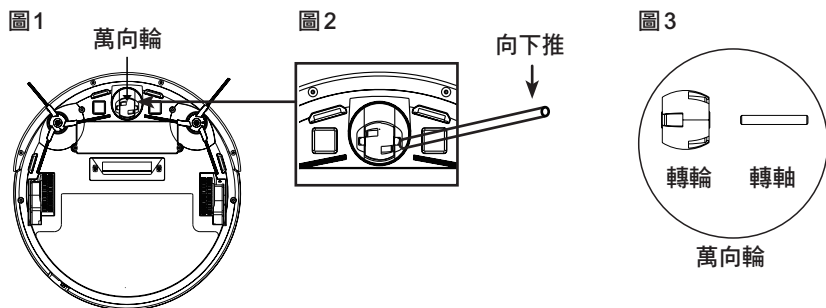

如圖所示，使用螺絲刀向下推並取下萬用輪，然後用乾布清潔流道和主軸。

充電極片

充電極片(主機右方) 充電極片(主機左方)

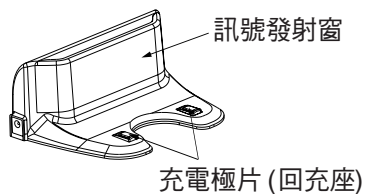
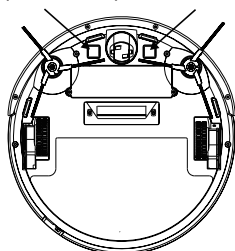

用乾布抹擦充電極片、回充極片和訊號發射窗，以確保吸塵機自動充電過程順暢。

吸塵機外殼

用乾布抹擦外殼。

注意：所有部件必須風乾完成後，才裝回機身。

疑難排除

問題	原因	解決方法
吸塵機不能工作	未開啟吸塵機機側主電源及機蓋頂AUTO鍵 ⓪	開啟主機電源開關鍵(配件6)及頂蓋AUTO鍵 ⓪ 電源(配件2)
	吸塵機電量耗盡	請參考第23頁“充電”部分
吸塵機不能充電	充電連接不良	確保火牛有效地連接
		擦拭回充和主機極片
吸塵機持續後退	地檢感應器有異物	用清潔布擦拭感應器
吸塵機原地打圈	吸塵機信號發射窗有異物	用清潔布擦拭信號發射窗
左/右輪異常,並聽到“Left wheel error” or “right wheel error” 聲響	輪子被異物纏繞	清除異物
左/右邊刷異常,並聽到“Left brush error” or “right brush error” 聲響	左/右邊刷安裝錯誤	將邊刷正確安裝。請參考第24頁“邊刷圖示”部分
組合容器盒(塵箱及水箱分隔設計)異常,並聽到“Dust box error” 聲響	組合容器盒未安裝到位	將組合容器盒安裝到位
萬向輪異響	萬向輪有雜物	取出萬向輪進行清理。請參考第33頁“萬向輪”部分
風機異常,並聽到“Vacuum motor error” 聲響	風機有雜物	聯絡客戶服務中心尋求協助
手機APP無法使用	網絡連接失敗	按說明書指示進行配網連接。請參考第27-31頁“手機APP 使用”部分
遙控器不靈	操作時距離主機太遠	有效範圍內對準AUTO鍵 ⓪ 進行操作 (3米內)
其他異常情況	不知明原因	重新啟動機器 (關閉主電源開關,將機器放在平坦的地方,然後再重開它。)

注意: 如果以上疑難未能解決問題,請聯繫本公司售後服務。請勿自行拆卸機器。

產品規格

型號： GWRVC15

電源： 14.6V

功率： 20瓦

電池： 2150mAh

產品尺寸：325 (闊) x 56 (高) x 325(深) 毫米

* 相關產品的規格，可能會因配件批次或實際使用地區的電壓差異而有所不同。

請記錄下列產品資料

- 型號

- 機身編號

- 經銷商名稱

- 購買日期

本產品不斷改進中，如功能有所更改，恕不另行通知，如有疑問，請與客戶服務中心聯絡，不便之處，敬請原諒。

說明書內容以英文版本為準

ToolBox Customer Service Centre 客戶服務中心：
4/F, DCH Building, 20 Kai Cheung Road, Kowloon Bay, Hong Kong
香港九龍灣啓祥道20號大昌行集團大廈4樓

Customer Service Hotline 客戶服務熱線：(852) 8210 8210
Service E-mail 電郵地址：8210service@gilman-group.com
Please register now at 請即上網登記：www.toolbox.hk
Website 網址：www.gilman-group.com



Proudly Serviced by:



太平家庭電器